



# Safety Instructions



0, 1, 2, 3, 4, 6, 7, 8, 9, 11,  
15, 18, 20, 22, 25, 26, 27



Info Hotline +49 (0) 5041 998 389

Mon. - Do. 7<sup>00</sup>-20<sup>00</sup>

Fr. 7<sup>00</sup>-17<sup>00</sup>

Paulmann Licht GmbH  
31832 Springe / Germany  
www.paulmann.com

Art.-Nr.:

66352

(+MA 173)

PEA 08/09

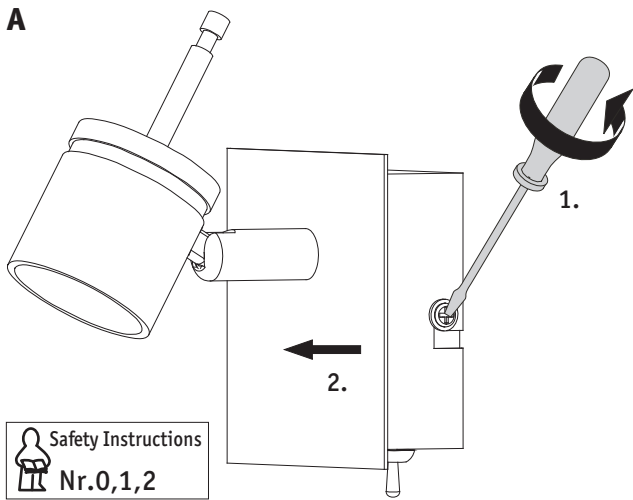
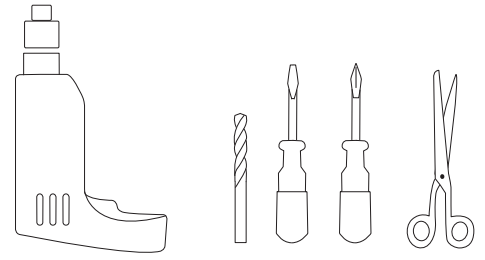
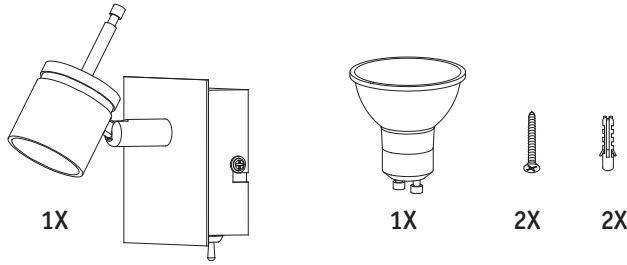

Safety Instructions  
Nr.0,1,2

