

SAFETY INSTRUCTIONS

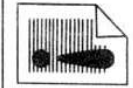

1,2,3,4,5b,6,7,8,9,10,11,
12,13,15,20,21,22,23,24

SAFETY INSTRUCTIONS



7^h - 20^h
Mon. - Fri.

PAULMANN LICHT GmbH
Quezinger Feld 2 • D-31832 Springe
www.Paulmann.com
+49 (0) 5041 998 389

- 1X
- 4X
- 2X
- 2X
- 2X
- 6X
- 4X

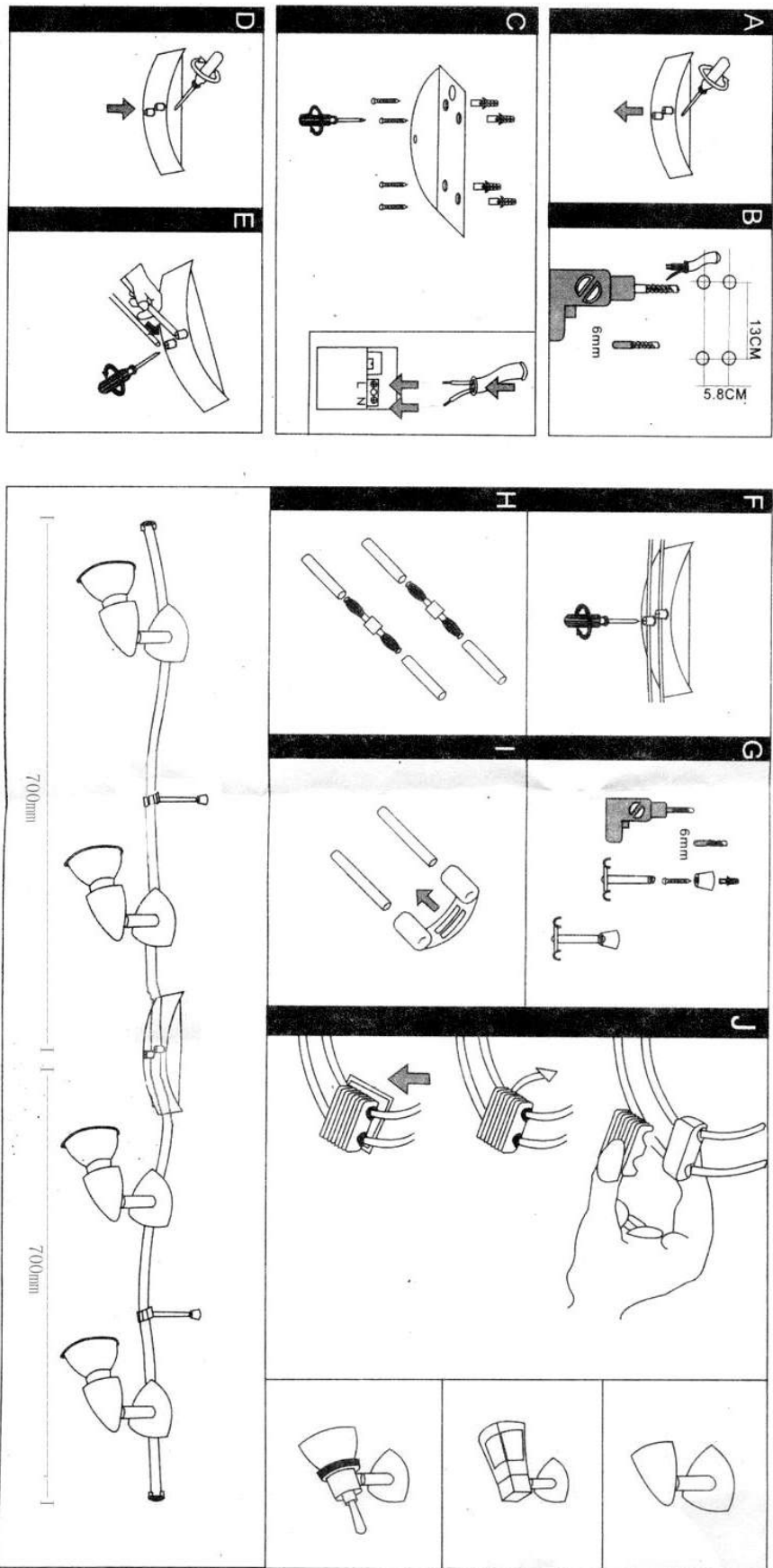
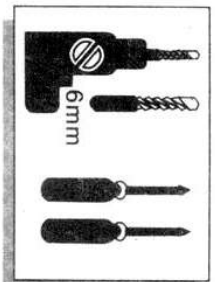

965.20/965.21/965.22/965.23/965.24/965.25/965.26
(+ MA 173)

Paulmann