

SAFETY INSTRUCTIONS



SAFETY INSTRUCTIONS

0, 1, 2, 3, 4, 5a, 6, 7, 8, 9, 10, 11, 14, 15, 16, 18, 20, 21, 22, 23, 24



INFO-LINE

PAULMANN LICHT GmbH
Quezinger Feld 2 • D-31832 Springe
www.Paulmann.com

+49 (0) 5041 998 389

7⁰⁰ - 20⁰⁰

7⁰⁰ - 17⁰⁰

Mo. - Do.

Fr.

- 1x105W(EI)
- 4x
- 2x
- 2x (0.5m)
- 5x
- 2x
- 2x
- 5x(20w)
- 4x
- 1x
- 4x
- 1x(S=2)
- 1x(10m)

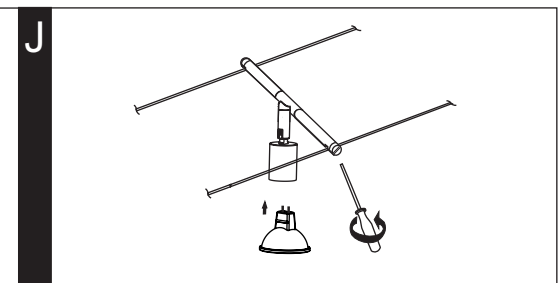
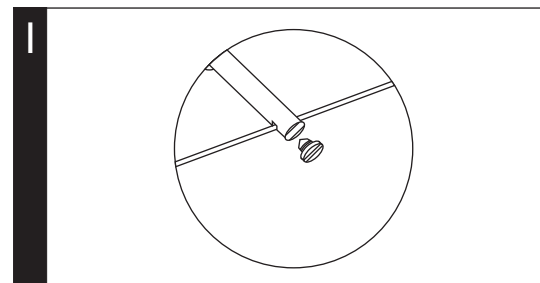
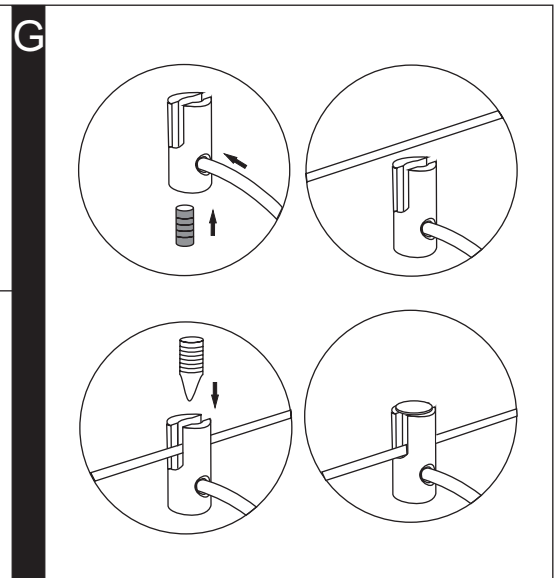
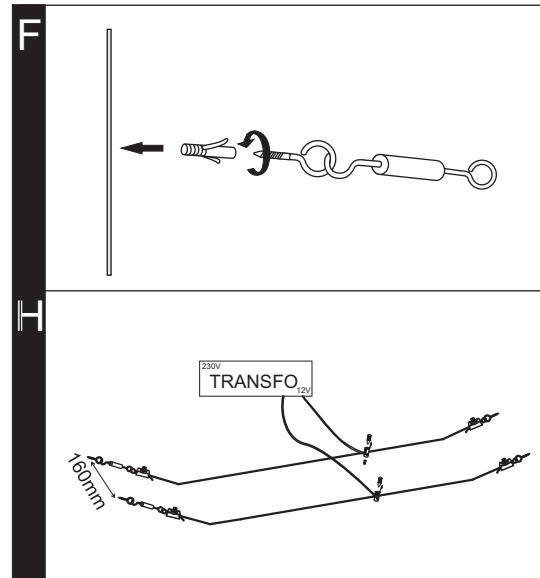
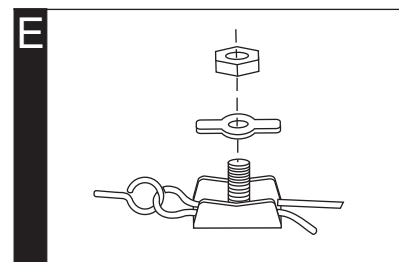
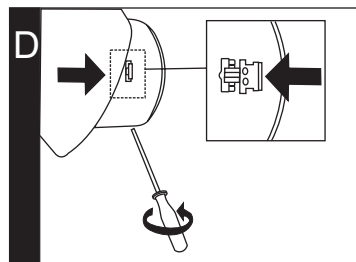
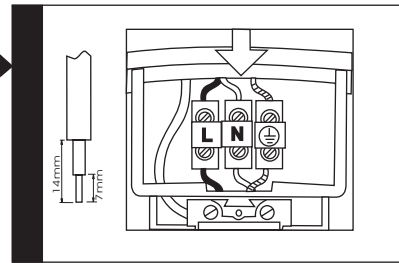
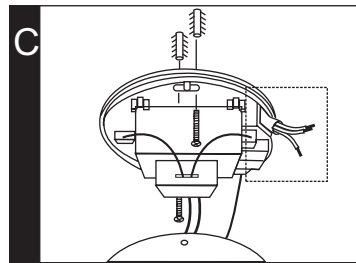
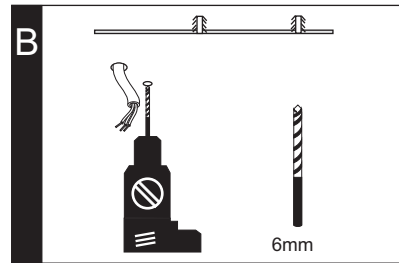
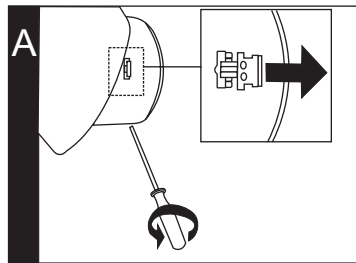
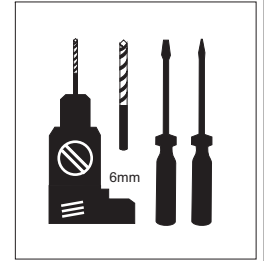

A B C D

